

NEWSLETTER

Chilham Water Mill
Mill Lane, Chilham
Kent CT4 8EE
Tel: 01227 730668
Fax: 01227 738894
Email: fisheries@southeastwater.co.uk
Web: www.midkentfisheries.co.uk



FEBRUARY 2009

Dear Member

Once again, I hope you all had a good Christmas and on behalf of all the staff at Mid Kent Fisheries I would like to take this opportunity to wish you all a very Happy New Year and thank you for your support. As you are aware the parent company is now South East Water.

MEMBERSHIP

Membership fees are due from the 1st April 2009, details are set out on the last page with your application form. We are once again offering you the chance to pay by cheque spread but please note that there will be a charge of £10 levied for every unpaid cheque. Anyone who issues a cheque without sufficient funds and does not settle this and any extra charges will lose their membership and be pursued through the courts for full payment. It only takes a phone call to Lin if you are experiencing problems – everyone has them so just call rather than let things slide. A stamped self addressed envelope for the return of your documents is very much appreciated as it takes twice as long when envelopes have to be written out.

Despite increased costs we have decided to keep the membership fees the same as 2008. We are of course aware of the increasing economic problems many members are having due to unemployment/fuel costs etc and we feel an increase would be unfair at these times. If you are in this situation or have other money problems, please contact us and we will do all we can to find a solution for you to be able to rejoin. I reduced the membership numbers by 100 last year from 850 down to 750 as I thought the lakes were getting too busy. This reduction had a dramatic effect and there were far more swims available even on a Friday night it was quite remarkable. Therefore we are keeping the numbers the same this year.

LARKFIELD NO 3

I have decided not to renew the lease on this venue after several discussions with English Nature and Cemex. As some of you may know this venue is a SSSI and therefore English Nature have total say as to what goes on at the site. We applied back in August to stock new carp only to be told that English Nature did not want any new bottom feeding fish stocked into the water. We also wanted to carry out work on the lake banks so that we had good access to swims and of course to renew swims, again to be told that English Nature did not want any disturbance of habitat. This has really made the site completely impractical to keep as we just have no control whatsoever. It is a crying shame as the lake could be a superb fishery but one has to be realistic.

NEW VENUE

Now for the good news, I have managed to get an agreement with Cemex to be able to fish Naccolt again for which I am really grateful and would thank Mick Barnes for. This, as some of the old members will tell you, was always a very popular water which we controlled for 10 years until Cemex brought the site a few years ago. We will share the water with Cemex members therefore the water will be restricted to six members a day booked in advance with the office, the same method used with Freemasons! Fabulous catches of tench can be caught here I have had over 20 tench in an evening session, big perch to 4lb and carp to 30lb, it really is a bonus to be able to bring this back into the club's fishing.

LEADCORE AND LEADERS

I have decided to lift the ban on leadcore and other leaders with the following provisos:

Leaders shown in the following diagrams, style and method, are the only type permitted.:-

Anyone (and I mean anyone) found using leadcore where hook lengths cannot be shed easily will face an immediate ban and loss of membership for life. The same goes for anyone using hook lengths stronger than their main line or rigs that could be deemed dangerous for fish. Baliffs will be given permission to check rigs regularly. This is your last chance, if we get to the same stage as last time then I will put in place a permanent ban with no further discussion or warnings.

RIVER FISHING AT CHILHAM AND THANINGTON

These are both sections reserved for fly fishing between April and October. I do allow three members per day (pre-booked with the office) to coarse fish the stretch at Chilham between November and February (not March). This does not apply to the section at Thanington so please, whoever you are, do not ring me instead of Lin hoping to get a yes. I do not want this stretch fished out of season so if any members see someone on there between November and March inclusive, please could they call us as they will be poachers.

THE FOLLOWING, WITH OUR THANKS, WAS KINDLY SUPPLIED BY DAVE LANE:

The idea of the Heli-Gripter bead is to create a safe helicopter rig when using Leadcore or thick solid nylon leaders.

The top (or release) bead is the crucial part of the set up and this bead has been designed with a hole bore three times the diameter of most standard beads. This, when combined with the large eyed swivel (supplied), ensures that the top bead and the hooklink can easily pass over the knot that secures the leader to the main line. So, should a breakage on the main line occur, the fish can dislodge the top bead with a flick of the head and the hooklink and bead will slide off the leader and off the main line where it has broken, leaving the fish with only the hooklink to eject. This will be far easier as it is not trailing a weight or a long length of heavy duty leader that could easily snag up and keep constant pressure on the hook-hold.

Carp are very adept at ejecting hooks if there is no pressure on the hooklink and this usually only takes a day or two in most normal situations. If you are unsure in anyway about the safety of a rig from a lead ejection point of view then there is a simple test you can perform.

Simply tie the rig up as normal and then hold the rig by the hook out in front of you at about waist height. With a small flick of the wrist that gently bounces the lead, the rig should work and the lead should discharge and hit the floor, completely free of the leader. If this is not happening then the lead is not safe. This test applies to both helicopter rigs and also lead release clips.



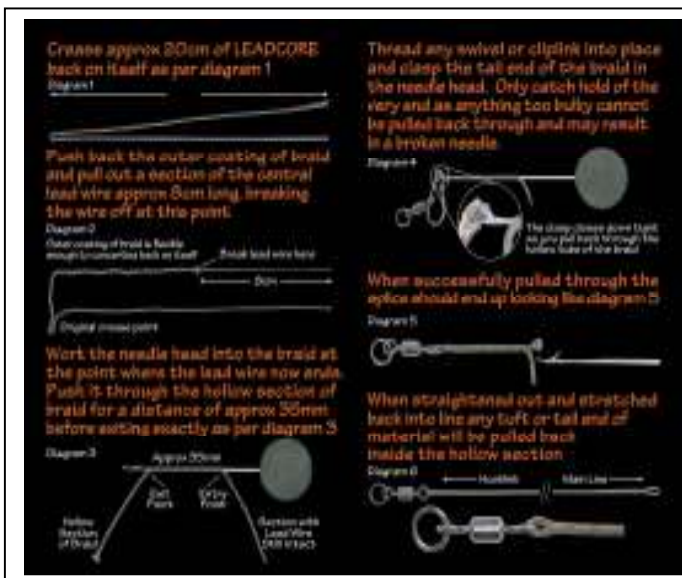
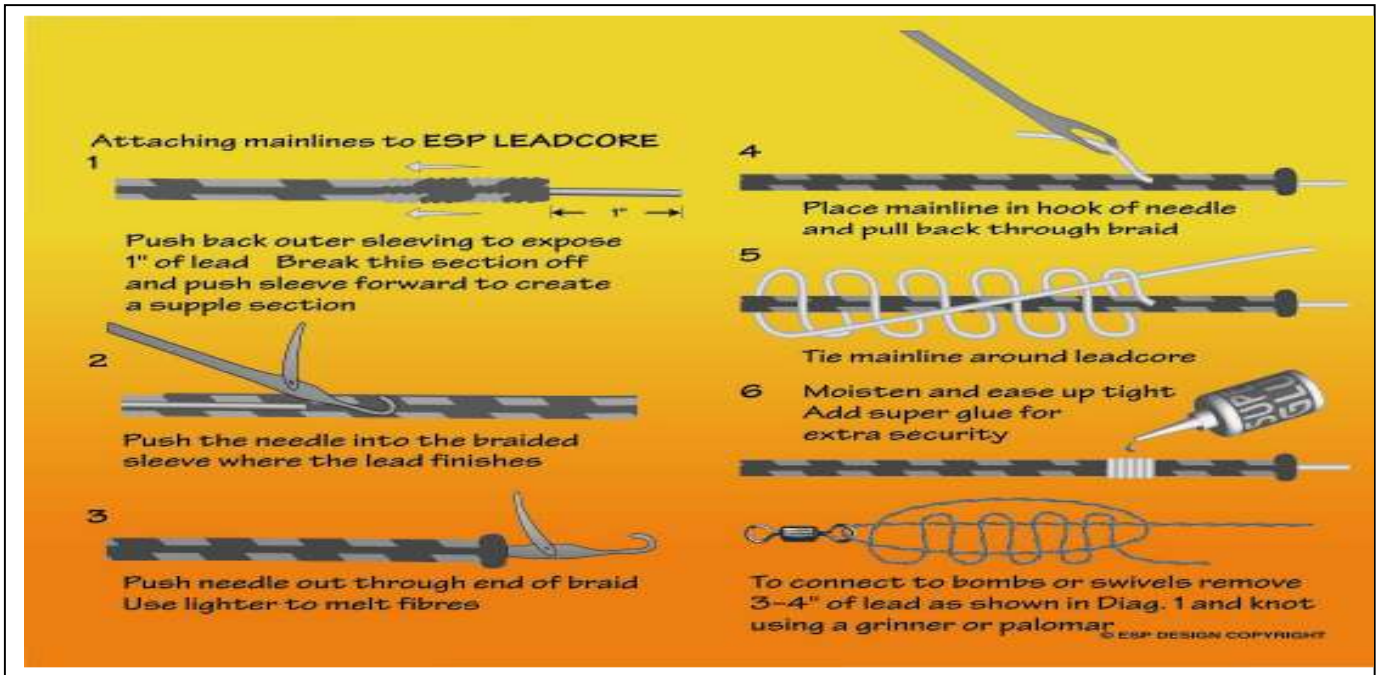

BAILIFFING

Any member wishing to be a bailiff will be asked to come along for an induction so that you know the rules and laws and how to handle situations that might arise. Please note that all bailiffs will be required to submit a weekly report (email, phone or written) to the office and Lin will copy these to Alan. If you cannot do this then please do not apply. Alan Turner is the Head Bailiff therefore either contact him direct or let Lin know in the office if you wish to be a bailiff. Alan is holding a bailiffs' meeting at Chilham Mill on Wednesday 25th March at 7-30pm for those who would like to come along.

BROCHURE AND RULE BOOK

If you have lost or need a brochure/rule book please let us know when applying. Likewise if you would like a copy of our DVD which illustrates our waters with many tips from some well known anglers please make a note on your application form.

LAKE CLOSURES

Chilham Lake will be closed the whole of May, we thought it best to get all the events over with in one month.

22 February	Members' Pike Match
2-4 May	British Carp Championship qualifier
8-19 May	Members' Pairs Match
15-17 May	British Carp Championship Qualifier
28-31 May	Fish with the Stars

To book your place on the Members' Match (only 15 pairs and it is very popular so book quickly) please call Lin. There is a fee of £50 per pair, this is payable no later than 1st May otherwise your place will be passed to someone else.

For information on Fish with the Stars, please contact Martin Ford at Carpworld on 01142580812 or email: martin@anglingpublications.co.uk.

Just for your information and to thank all those who supported the Fish with the Stars event, we raised over £6000 which I think is truly remarkable in one weekend, you are to be applauded. The two charities were overwhelmed especially the kids' home in Sturry so from them a big big thank you, lets hope we can do the same this year!

DOGS

As you know, we allow you to bring dogs to our venues, if they are kept under strict control. However, this is restricted to only two dogs per member please!

TOILETS

The toilet block at Chilham is fed by a cesspit to the mains at the A28 via a 2" pipe. Please could everyone be aware that you must not put anything in the loos apart from loo paper. No face or baby wipes or those fancy loo wipes, no nappies or personal female items – they are constantly having to be unblocked and the cesspit emptied because everything builds up and blocks the transfer pipe. Small plastic bags have been placed in the loos for your use which please place in the bins. We are awaiting the installation of special sealed bins in the loos.

GUESTS

Guests may fish nights between November and March – days only between April and October. Guests can only fish Chilham, Stour, Loggies, Reed, Blue Lagoon and Larkfield. Guests tickets can be bought in advance from the office but you must have your ticket before fishing. They are £25 per 24 hours or part thereof.

JUNIORS

Don't forget that juniors must apply for a permit to fish nights on their own unless they have attended and passed through the Korda Academy.

FISH REPORTS

Again, could I remind you to let me have your catch reports so that they can be posted on the forum and this year, we will post them in the shed at Chilham and in the office so that people without the internet can access them.

PADLOCK NUMBER

This will change on 1st April 2009 – the new number is on the Information Sheet that will be sent out with your new membership card.

HOP FARM RIVER MEDWAY

Entry through this venue is closed until we are able to negotiate with the new owners.

OVERVIEW OF THE 2008/09 SEASON SO FAR

CHILHAM

Although a bad season with regard to the weed, those who persevered had some very good results. The carp record continued to be broken and is currently up to 46lb8oz with three other known 40's. Cats are now over 60lb so don't dangle your toes in! Hopefully the couple of weeks when the lakes were frozen has killed off the weed.

STOUR

A very good year for carp, tench and pike, especially the winter carp fishing.

MILTON COMPLEX

This complex continues to go from strength to strength with all four of the lakes now having carp to over 40lb being reported. The winter pike fishing has been very good and the tench fishing on the pan and handle is regarded as being some of the best in the country. I would ask members who fish the Handle especially, if you lose rigs then please let us know. We will not be angry we would rather get the rigs out then let fish get hung up!!

CONNINGBROOK

The usual Brook, with Two Tone still putting on weight. Those who put the effort in seemed to get rewarded. To pre-warn you all, there are plans afoot to use the Brook as part of the training venues for 2012, I of course am fighting the angler's corner and resisting any change but I think compromises will have to be made. The quarry itself has now been mothballed because of the present decline in building, therefore I ask all members to be extra vigilant with regard to people being on the site who shouldn't be. If you see anything suspicious please ring the office or the police immediately do not ignore it, remember we are on this site by way of a lease which asks us police the site. There have been several rumours regarding the site all of which have been untrue, I will keep you all informed of any changes.

LOGGIES

The introduction of some extra carp has proved popular and they are fast gaining weight, the lake is maturing nicely. This lake also produced many good tench to members whilst carp fishing, therefore I would ask members to net or sack them up if they catch them and contact the office and we will come down and re-locate them into the Lagoon or Reed Lake.

LAGOON AND REED

Produced some great pleasure catches as usual with tench and bream into double figures. Best pike at the time of writing 29lb. We are hoping to net some more very large bream in May and stock them into these lakes.

MATCH LAKE

Fished very well this year and has proved popular with the match men with lots of match weights over 100lb. Many thanks to Mick Wright for organizing some of the matches

HARRIETSHAM & ST CLERE

Still great fun for the pleasure angler. Remember you must book these venues.

LYDD

Fish weights continue to improve. The small lake has been stocked and is now fishable. The third lakes lease has now been secured and will be stocked this year.

FAVERSHAM

Continues to provide good sport to the few members who fish there with several good carp to 30lb from the Mill together with some very large bream. It continues to be a big problem regarding poaching and litter I hoped us allowing Faversham Angling Club to share the venue would help the situation but it hasn't therefore I have to appraise that situation. I have a meeting with the local police arranged at the time of writing this newsletter to see if we can improve the situation by taking a few of the vermin to court, I will let you know the outcome.

WESTBERE

Continues to produce good bags of all species. Many thanks to the lads that run all the matches and Tim and his merry band of workers for their hard work on the work parties. Remember there is a close season on this venue as it is a SSSI. We do have a lot of work again this close season so any help would be appreciated.

LARKFIELD

Fished well this year especially No.2. Security has dramatically improved with very few problems reported this current season. The joint venture with Freemasons has worked well. I would like to express my thanks to Ted and Duke for all their efforts in policing the site and the other lads who also help out, your help is greatly appreciated. I would also like to congratulate Ted on winning the Fox cup to add to his collection of Drennen titles, watch it mate your becoming a superstar!!!! Well done mate great fishing.

FREEMASONS

The addition of this venue has been a great asset and proved very popular with the members. It has produced many 30lb+ carp and a few 40's this season together with some very good pike.

Just to clear up one point, we actually hold a five year lease on this lake and we sub-let it to Freemasons Angling Club. Remember to pre-book this venue. Also ensure you have a set of the Freemasons rules which should be handed to you when you buy a key.

ROYAL MILITARY CANAL

Remember there is a closed season on this venue as it is a SSSI. Day tickets are also available on this venue either from the Post Office in Appledore or from Tim Hobday during his bailiff rounds. We are pressing the owners the Environment Agency to carry out surveys on the whole of the canal. We also want to stop the release of water in the manner it is currently done which washes all the juvenile fish out to sea. We are winning but it is a slow process. Once again I would express my appreciation and thanks to Tim for his bailiffing – he puts up with some very rude people!

LITTLETON SOUTH AND NORTH LAKES

Continue to fish well with several thirties and a couple of forties being caught together with some good catches of bream and roach. My sincere thanks goes out to Nick Hook who bailiffs and looks after this venue on our behalf, he works tirelessly at the venue repairing fences and swims etc. plus bailiffing a really great effort.

STAINES

I know you are all saying when are you going to stock this water and believe me I am as frustrated at the situation as you are. The problem is there is still no decision as to what is the long time future of the lake there has been all manner of plans put forward even to build a housing estate. Therefore I have no intention of spending lots of money on fish stocks only to be told we have lost the lake. If and when I get a long lease of at least 5 years I will then stock the lake.

THAMES SONNING

Still catching big barbel and other species - remember you must book and collect a permit from the office during office hours.

WORK PARTIES

Many members have expressed their wish to take part in work parties on the lakes. I have always believed it is a good thing to get members involved as it makes you feel that you are part of the club. If you see some idiot causing problems you are more likely to sort them out, especially if they are destroying something you have worked on. Therefore from Saturday February the 28th we will be running work parties on the lakes for those who are interested every Saturday morning. If you are interested give the office a call or email and it will give us some idea of numbers. Who knows it could get you started in the business - it's the way

AND FINALLY

Once again, many thanks to Keith, Chris Junior and Lin for their hard work in keeping the fisheries one of the best in the UK. My sincere thanks goes out to Alan Turner who puts in a considerable amount of time bailiffing and organising the same, Ted, Duke, Kevin for Larkfield, Tim Denning for all his efforts at Westbere, Tim Hobday for the Canal and many many thanks to the volunteer bailiffs and all those members who continue to support us, without you it would not happen - thank you.

Chris Logsdon

RENEWALS

If you wish to upgrade to Tier 1, please submit your application on this basis. Applications are numbered when received and allotted on a first come first served basis. Existing Tier 1 members have until March the 14th to rejoin or let Lin know of your intention to rejoin - after this you could lose your place.

Existing members should supply one photo (check with the office as we may already have extras). Do not send in your current membership card as it will be needed to fish the remainder of the season.

Tier 1: All waters under our control. No discounts for this Tier.

Tier 2: All waters except Conningbrook.

Tier 3: Westbere, Blue Lagoon, Reed Lake, Naccolt, Mill Pool, Wood Pool, Match Lake, Harrietsham, St Clere, River Medway at East Peckham, River Stour at Canterbury, Royal Military Canal at Appledore, the Rope Walk at Sandwich.

Tier 4: Larkefield Complex (also known as Leybourne) – four lakes – No 2, Road & Island, Ocean and Railway. This tier does not cover Freemasons.

FEES:

Type of Membership	Tier 1	Tier 2	Tier 3	Tier 4
Adult	350	275	95	175
Partner	350	140	50	100
Junior*	350	140	50	100
Pensioner or Disabled #	350	250	85	150

KEYS

Staines	£10	Larkfield	£10
Conningbrook	£20	Faversham/Lydd	£10
Westbere	£20	Freemasons	£20

Plastic Tax Disc Holder	0.50p each
-------------------------	------------

* Juniors must be under 16 at 1st April 2009

Proof required

PLEASE MAKE YOUR CHEQUES AND POSTAL ORDERS PAYABLE TO "SOUTH EAST WATER"

Payment can be made by cash or cheque - we do not accept cards. If joining in April or earlier, you can spread the payments over 5 months by cheque but all five post dated cheques must accompany your application or it will be returned to you. Last cheque to be dated no later than 31 August 2010. **NO REFUNDS** will be given once application has been processed. Please send completed form and enclosures, together with a stamped addressed envelope for the return of your documents, to:

Mid Kent Fisheries, Chilham Water Mill, Mill Lane, Chilham, Kent CT4 8EE 



MID KENT FISHERIES: MEMBERSHIP FORM: SEASON 1/4/09 TO 31/3/10

NAME		MEMBERSHIP NO:	
ADDRESS		CAR REGISTRATION NUMBER(S)	
EMAIL:			
TELEPHONE	DATE OF BIRTH : UNDER 16 ONLY (proof required for new members)	DISABLED : PLEASE ATTACH COPY OF BLUE BADGE PENSION NO: (proof required for new members)	

TYPE OF MEMBERSHIP APPLIED FOR (PLEASE INDICATE)

TOTALS £

TIER 1	TIER 2			TIER 3		TIER 4	
KEYS	C'BROOK £20	STAINES £10	W'BERE £20	L/FIELD £10	LYDD/FAV £10	FREEMASONS £20	
MKF TAX DISC HOLDER FOR CAR PERMIT @ 50P EACH							
CHEQUES : 1 OR 5 CASH OR POSTAL ORDERS Please delete as appropriate				Office use Only: DATE ISSUED:			TOTAL ENCLOSED 